

# OPERATING INSTRUCTIONS {CONT.}

## CLEARING A JAM

**1** After removing tube from nozzle, (Fig 1) open the Chamber Guard, (Fig 2) then turn the Power Switch off. (Fig 3)

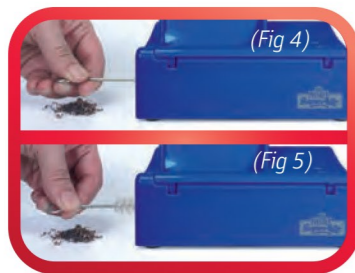
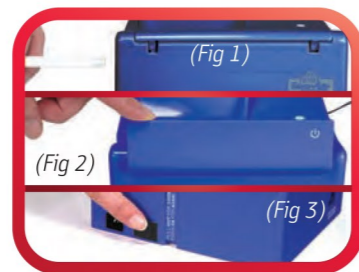

**2** Use the Clearing Rod (Fig 4) and Nozzle brush (Fig 5) to remove all tobacco from the Tobacco Chamber.



**3** Turn the Power Switch on (Fig 6) and close the Chamber Guard. (Fig 7)



**4** Keeping FINGERS and HANDS AWAY FROM NOZZLE OPENING, press AND release the start button to activate the injector sequence, clearing the remainder of the jam. (Fig 8) Your SuperAuto™ is now ready for use.



## Maintenance, Care & Handling

- Keep cigarette machine out of reach of children.
- Clean tobacco chamber and nozzle after every use.
- Clean your machine regularly by removing tobacco residue from tobacco chamber with the supplied Clearing Rod and Nozzle Brush.
- Do not immerse machine in water.
- **This appliance is only to be used with the power supply unit provided with the appliance.**
- Household and Indoor use only.

**!** The use of other adaptors will void the warranty.

**!** Do not overfill the tobacco chamber! Doing so will cause your SuperAuto to jam.

**!** Always keep hands/fingers away from nozzle opening & tobacco chamber when pressing the 'start' button to avoid cuts & lacerations. Extended injector is very sharp!



### SUPERAUTO™ REPAIR SERVICE CENTER

**Republic Brands**  
2301 Ravine Way, Glenview, IL 60025  
T: (855) 796-4357 F: (855) 832-0246  
email: [superauto@ryoservice.com](mailto:superauto@ryoservice.com)  
web: [www.ryoservice.com](http://www.ryoservice.com)

### ADDITIONAL WARRANTY INFORMATION

This appliance is not intended for use by persons with reduced physical, sensory or mental capabilities, or lack of experience and knowledge, unless they have been given supervision or instruction concerning use of the appliance by a person responsible for their safety.

#### ADDITIONAL WARRANTY LIMITATIONS

The included one year, one time limited warranty is your exclusive warranty and it replaces all other warranties or conditions, expressed or implied, including, but not limited to, the implied warranties or conditions of merchantability and fitness for a particular purpose. These warranties give you specific legal rights and you may also have other rights which vary from jurisdiction to jurisdiction. Some jurisdictions do not allow the exclusion or limitation of expressed or implied warranties, so the above exclusion or limitation may not apply to you. In that event, such warranties are limited in duration to the warranty period. No warranties apply after that period.

#### REMEDY LIMITATIONS

In no event shall the company be liable for special, incidental, or consequential damages to the purchaser or to any third party, including, without limitation, damages arising from loss of property, economic loss, lost profits, loss of business opportunity, or statutory or exemplary damages, whether from negligence, warranty, strict liability or under any legal theory in contract, tort, or otherwise. Some states do not allow the exclusion or limitation of special, incidental, or consequential damages, so the above limitation may not apply to you.

#### RETURN PROCEDURE

Any product returned under this one year, one time limited warranty should be sent by the customer via prepaid mail or courier to the service center located at 2301 Ravine Way, Glenview, IL 60025, U.S.A. Please include with the returned product twelve dollars and fifty cents (US \$12.50) for return shipping and handling. The company assumes no responsibility whatsoever for any loss or damage during shipping and the customer is solely responsible for any such loss or damage. Note: Please do not return the product to the store where you bought it for service as they are not authorized to service the product.

PLEASE SEE THE ENCLOSED ONE YEAR, ONE TIME LIMITED WARRANTY CARD FOR MORE INFORMATION ON YOUR SUPERAUTO™ CIGARETTE MACHINE WARRANTY



Electric King Size & 100MM Cigarette Machine

## Owner's Manual

©Republic Brands

Australia Des. Pat. No. 358808, Australia Patent No. 2013205376, Austria Des. Pat. No. 66760, Austria Utility Patent No. 14918, Austria Patent No. 14351, Belgium Patent No. 1022932, Belgium Patent No. 102166481, Benelux Des. Pat. No. 40106-00, Canada Des. Pat. No. 159387, Canada Patent No. 2813447, China Des. Pat. No. ZL 201430448906.0, China Utility Patent No. ZL201520241739.1, China Patent No. ZL201210184284.5, China Utility Model No. ZL201420375819.1, France Des. Pat. No. 2014-4955, Germany Des. Pat. No. 402014101092.7, Hungary Des. Pat. No. 92227, Hungary Patent No. 230626, Luxembourg Patent No. 92722, Luxembourg Patent No. 92183, Netherlands Patent No. 2010682, Netherlands Patent No. 2014375, Poland Des. Pat. No. Rp21599, Spain Des. Pat. No. 0520280, Spain Patent No. 2578187, Spain Patent No. 2450715, Turkey Des. Pat. No. 2014/07366, Turkey Patent No. 201304812, United Kingdom Des. Pat. No. 7038019, United Kingdom Patent No. 2503327, United States Des. Pat. No. D769,521, United States Pat. No. 9,949,503, United States Patent No. 9314051, United States Patent No. 9414625, other applications pending.

# READ BEFORE OPERATING YOUR PREMIER® SUPERAUTO™ CIGARETTE MACHINE

Thank You for your purchase of the Premier® SuperAuto™ Electric Cigarette Machine.

Premier® presents our newest addition to our trusted line, the new SuperAuto™ Electric King Size & 100MM Cigarette Machine. Its one-touch operation makes it extremely easy to use. The chamber guard is an additional safety feature and tools are included for cleaning to keep your SuperAuto running smoothly.

maintenance requirements will keep your machine in optimal working order for years to come.

Your Premier SuperAuto™ must be registered within 30 days of purchase for warranty and service agreement to be valid.

Please carefully read the instructions first before operating your machine! Following the simple

## GETTING TO KNOW YOUR SUPERAUTO™ ELECTRIC CIGARETTE MACHINE



## OPERATING INSTRUCTIONS

- 1 Plug in the SuperAuto™ and turn the power switch on. (Fig A)

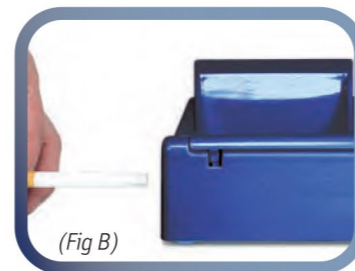

- 2 Slide the open end of a cigarette tube onto nozzle. (Fig B)

- 3 Open the Chamber Guard. (Fig C)

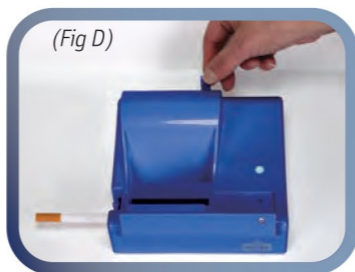
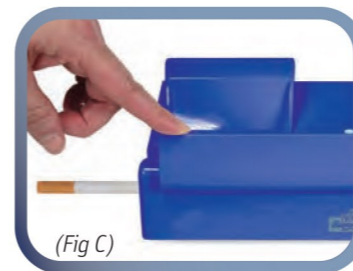

- 4 SuperAuto™ is set to make King Size cigarettes by default. To make 100MM, slide the cigarette size lever at the rear of the machine all the way out. (Fig D)

## OPERATING INSTRUCTIONS (CONT.)

- 5 Filling the corners first, deposit tobacco evenly in the Tobacco Chamber. DO NOT OVERFILL! (Fig E)



- 6 Use the Tamper to pack tobacco down evenly in the tobacco chamber. (Fig F)

- 7 Close the chamber guard (Fig G) then press AND release the start button to activate injector sequence. (Fig H) \*Turn off unit when not in use.

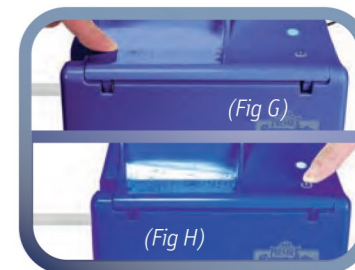

**!** In the event of a jam, the machine will reset injector to the starting position & jam indicator light will flash red.

to clear a jam follow these steps >